

# Drilling and milling head, straight collet chuck, ER20A, PRECI-FLEX®, CC external coolant supply

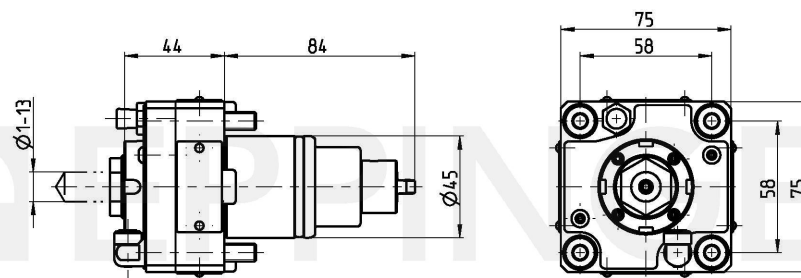

**Part Number**      **1087976**  
**for**                      **EMCO Hyperturn 45 (BMT45)**

Ratio                      **1:1**  
rpm at Input            **max. 6000 rpm**  
rpm at Output          **max. 6000 rpm**  
Torque at Output       **max. 25 Nm**  
Direction of Rotation     
Scope of Delivery      **without wrench and collets**  
AccessoriesCollets see Equipment for Toolholders Z2.  
Wrench for spindle 0.002.325  
PRECI-FLEX® Adapter  
Protection cover for spindle see P99.1

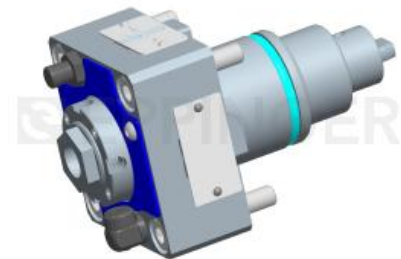

Technical Data Subject to Change

05.07.2022 | 14.04.2023

EPPINGER USA | 9930 East 56th Street | Indianapolis, IN 46236 | Phone : 352.588.4345 | Toll-Free: 800.397.9748 | [www.eppinger.com](http://www.eppinger.com)